

- Designed to meet UL 60950
- Working voltage up to 250Vrms
- Excellent THD performance
- ROHS Compliance Product
- Operating Temperature range: -40°C TO +85°C



Electrical Specifications @ 25°C

P/N	T/R	OCL@10KHz 0.1V		LL@100KHz 0.1V	Hi-Pot	
MP0636F	(1-5):(10-6),(tie2+4,9+7)	(1-5),(tie2+4)		(1-5),(tie2+4, 6+7+9+10)	PRI TO SEC	
	1.6:1 ±2%	410µH±5%		10µH MAX	1875VAC,1mA 2S	
	DCR			CWW@100KHz 0.1V	THD	
	1-4	2-5	9-6	10-9	(1-10),(tie1+2+4+5,6+7+9+10)	30KHZ 4.5V
	0.6Ω MAX	0.6Ω MAX	0.5Ω MAX	0.4Ω MAX	35pF MAX	-80dB MAX

DIMENSIONS (unit: inch/mm):

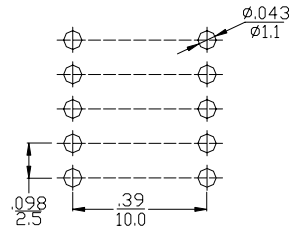
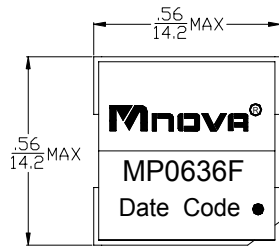

PCB LAYOUT

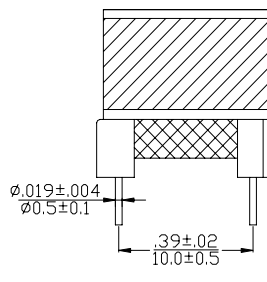
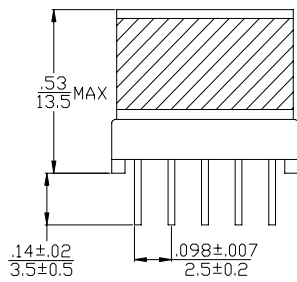

CUT:PIN 3

SCHEMATICS:

