

- TRANSFORMER
- Isolation transformer specification
- ROHS Compliance Product
- Operating Temperature range:-40℃ TO +85℃.

Electrical Specifications@25℃					
P/N	T/R@60KHz 1V	DCR	OCL@100KHz 0.1V 8mA DC	LL@100KHz 0.1V	Hi-Pot
MS0767	(1-3):(6-4)	(1-4)&(6-5)	(1-3)	/	PRI TO SEC
	1CT:1.15CT±5%	0.17Ω MAX	750μH MIN	/	2000V AC 1mA 6S

DIMENSIONS (unit: inch/mm):

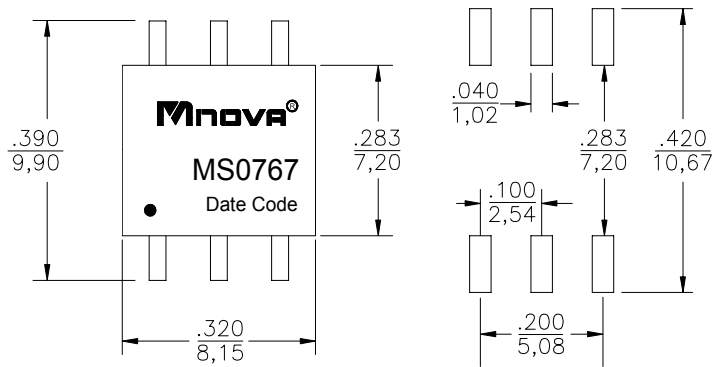

recommend PAD layout

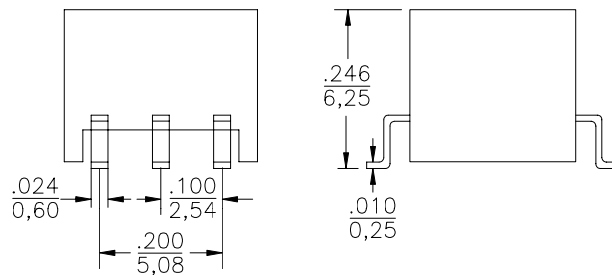

Note:Unless otherwise specified,all tolerances are:± $\frac{.012}{0,30}$

SCHEMATICS:

